

# Connecting Anything with MuleSoft

Aj De Guzman

# Hi, I'm @AjDeGuzman!

- mulesoft developer
- 9+ yrs IT industry
- 2 yrs in academe

# Tech Skills Journey

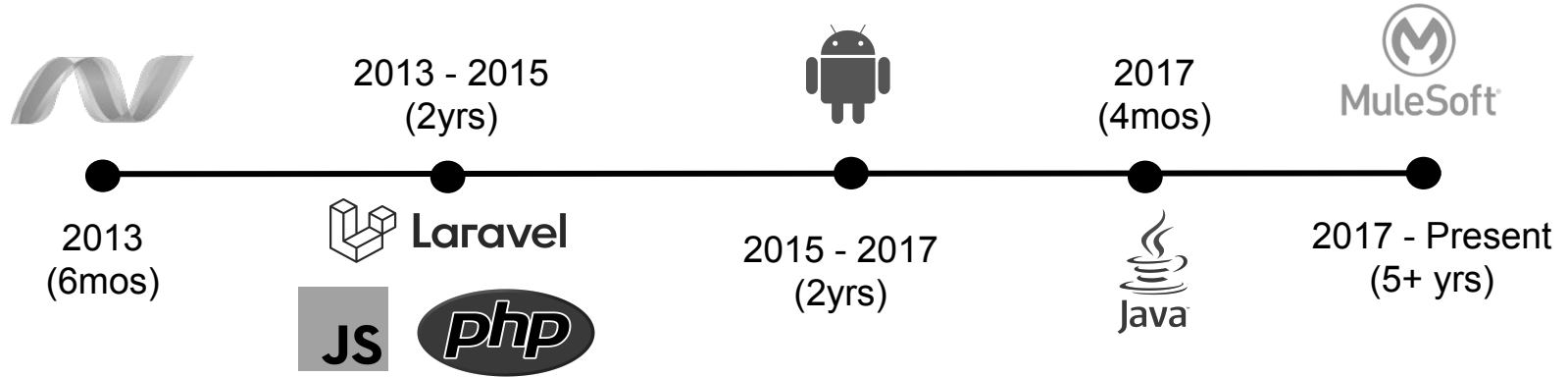

API Integration

Internet of Things (IOT) Integration

Software Integration

Mobile Apps Integration

(Any) Integration

“Anything that can be  
connected, will be  
connected.”

# API Integration

# API

application programming interface

# API

a way to communicate



# API

it is everywhere

# API RESTAURANT ANALOGY

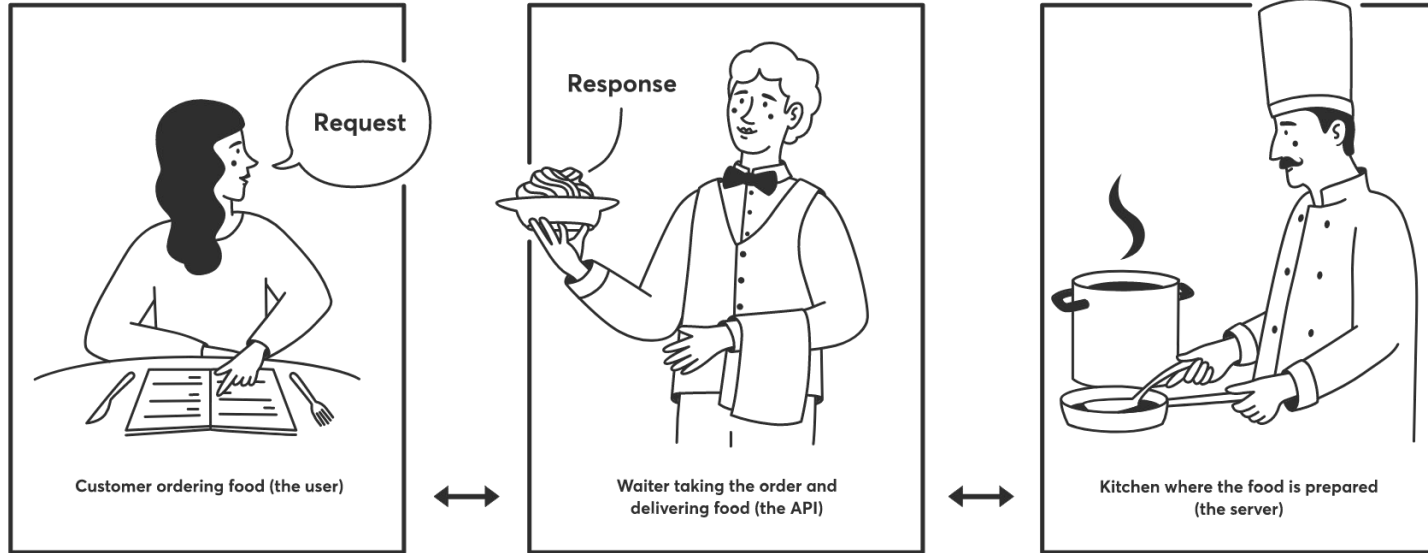

# API Integration

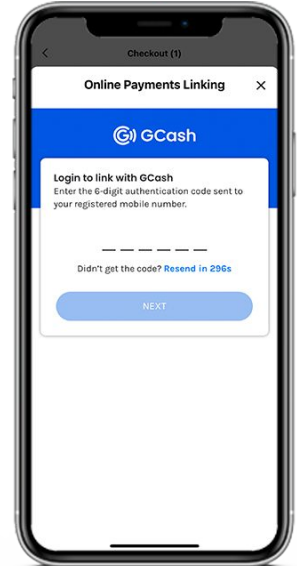
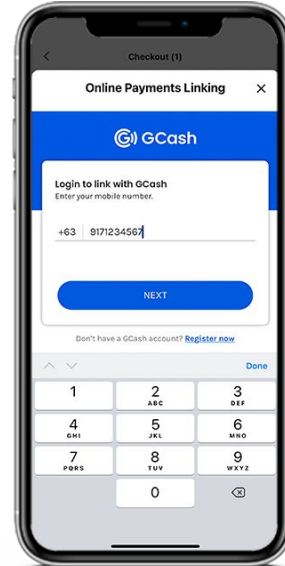
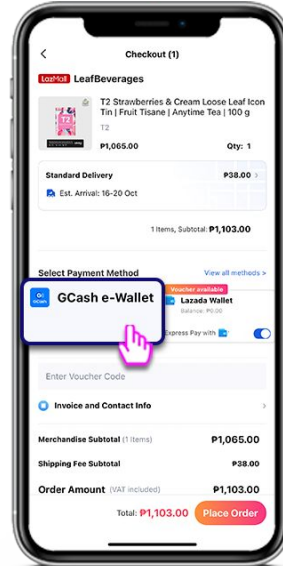

# API Integration

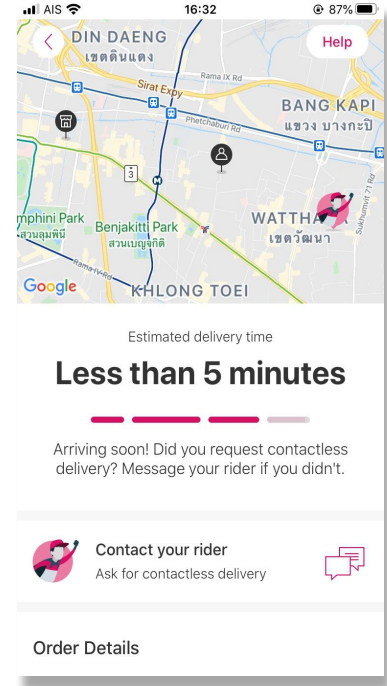
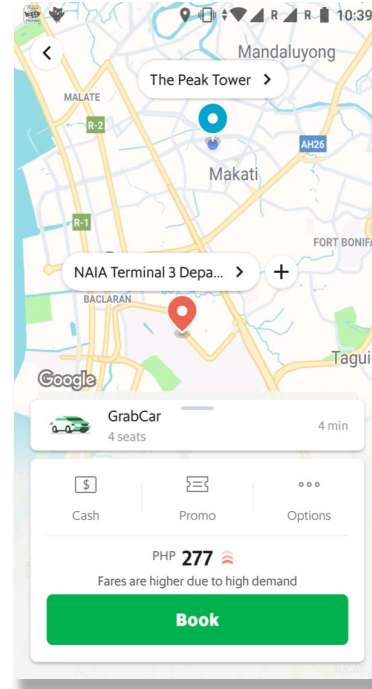

# API Lifecycle

# API Lifecycle

design > dev & test > deploy > manage

# Integration

so... what are we trying to solve here?

# Point-to-point Integration



# Complexity with Point-to-point Integration

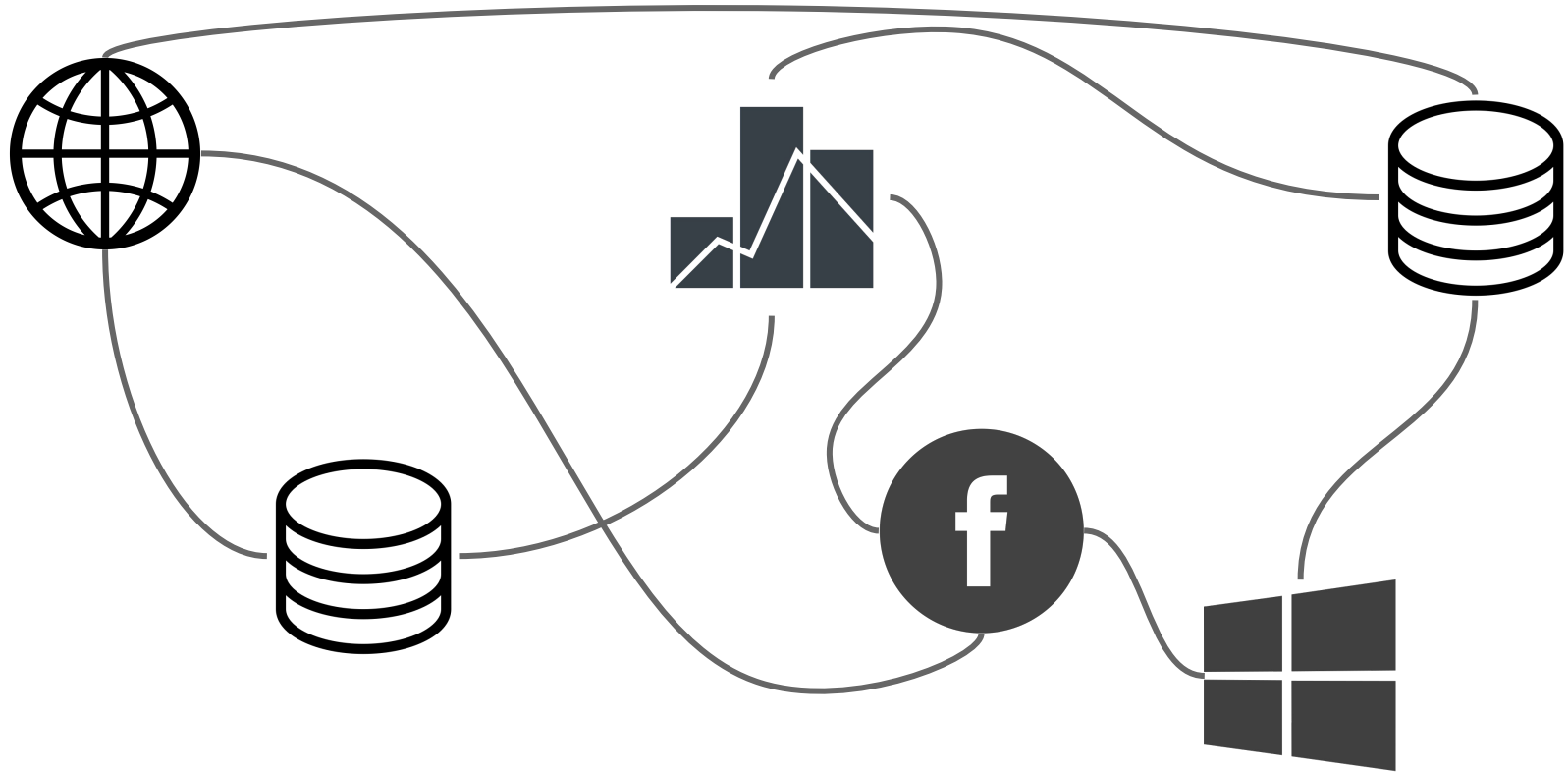



Single Connectivity Platform

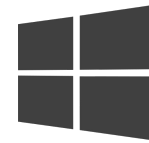

What is MuleSoft?

What is MuleSoft's  
Anypoint Platform?

# Anypoint Platform

- API Designer (Designing APIs)
- Anypoint Studio (Building & Testing APIs)
- Runtime Manager (Deploying API)
- Anypoint Exchange (Sharing APIs)
- Anypoint Monitoring (Monitoring API)

# Integration

api > mulesoft > anypoint platform

# API Design

# API Design

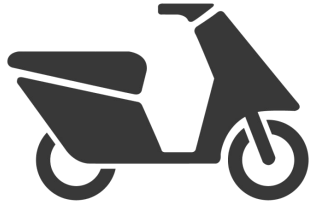

**ANGKAS**

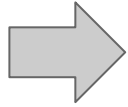

**API**

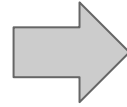

**Google Maps**

- Geocodes
- Distance
- Places



# API Design



- Retrieve Albums
- Retrieve Artists
- Retrieve Liked Songs

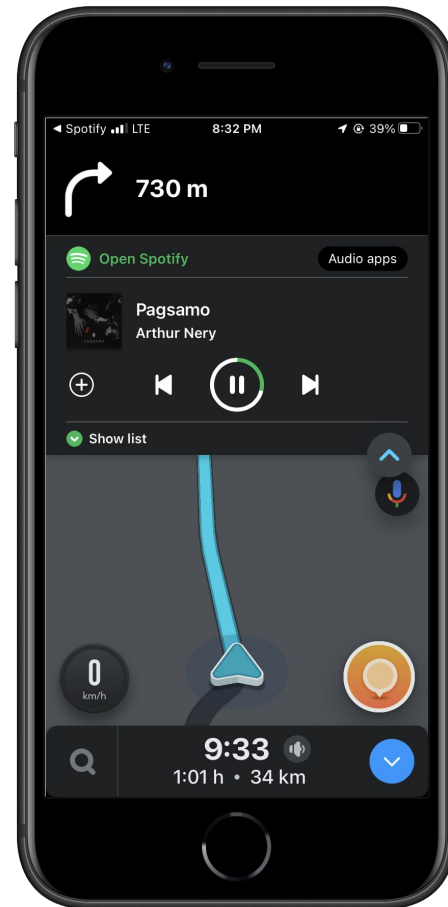

# Recap:

- Integration
- API
- API Lifecycle
- MuleSoft Anypoint Platform
- API Design
- RAML - API Designing Language



# HTTP Basics

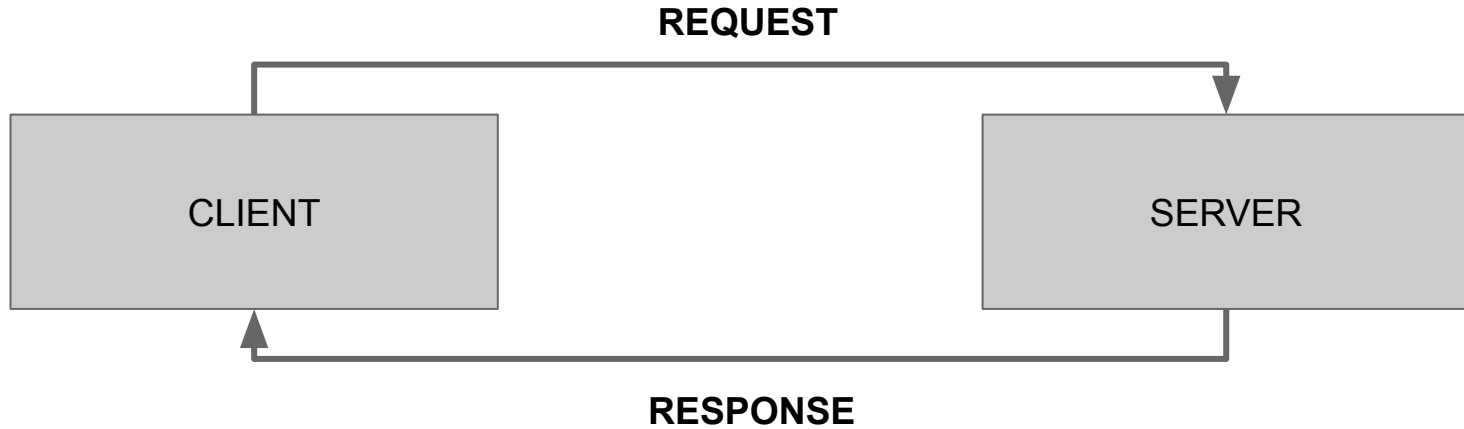

# HTTP Verbs

POST - Create

GET - Retrieve, Read

PUT - Update, Replace

PATCH - Update, Modify

DELETE - Delete, Remove

# HTTP STATUS CODE

- 200 - OK
- 201 - Created
- 400 - Bad Request
- 401 - Unauthorized
- 404 - Not Found
- 500 - Internal Server Error

# API Design



- Retrieve Albums
- Retrieve Artists
- Retrieve Liked Songs

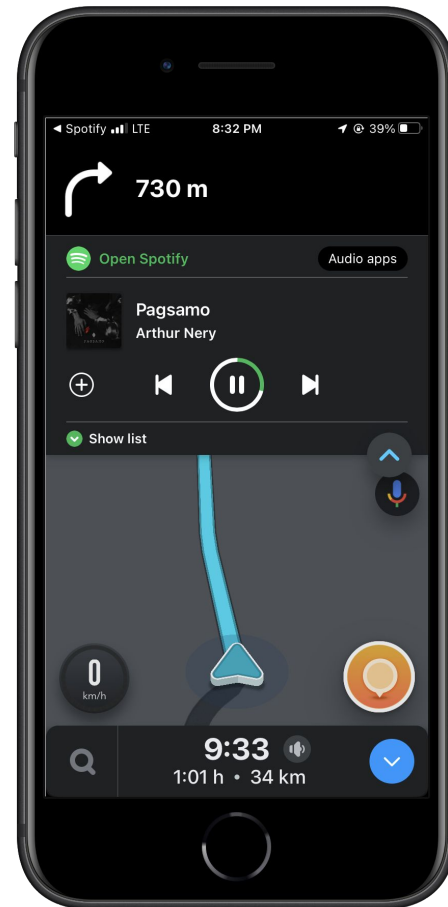

# RAML

RESTful api modeling language

# RAML

...your API's Blueprint

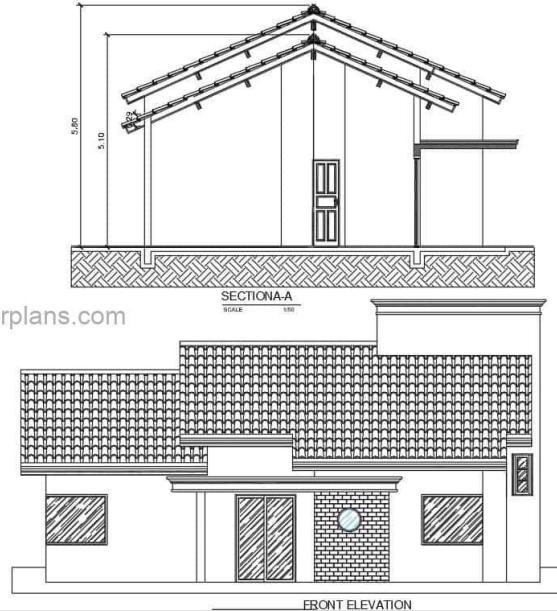
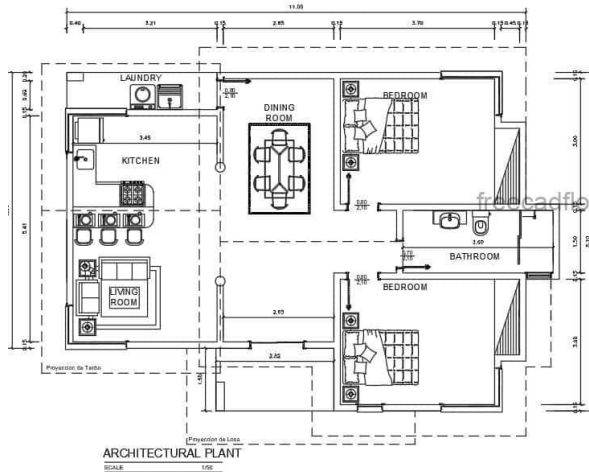



# RAML

```
1  #%RAML 1.0
2  title: JobAPI
3  baseUri: http://allItJobs.com
4  mediaType: application/json
5  types:
6  |   job: !include datatypes/Job.raml
7
8  /jobs:
9  |   get:
10 |     headers:
11 |       Accept:
12 |     responses:
13 |       200:
14 |         body:
15 |           | | | type: job[]
16 |     post:
17 |       headers:
18 |         Content-Type:
19 |       body:
20 |         | | | job
21 |       responses:
22 |         201:
```

# Integration Scenario

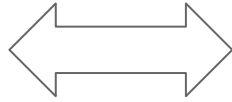

**API**

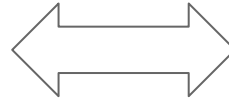

- Word Definition
- Synonyms
- Antonyms

# Anypoint Platform

- API Designer (Designing APIs)
- Anypoint Studio (Building & Testing APIs)
- Runtime Manager (Deploying API)
- Anypoint Exchange (Sharing APIs)
- Anypoint Monitoring (Monitoring API)

<live demo>

What's next?

# Continue Learning

<https://training.mulesoft.com>

<https://help.mulesoft.com/s/forum>

< q&a >